

AST - Current transformers line

Compact design, versatility and greater safety are the distinctive features of the new AST-Line. In developing we have moreover retained our reliable CELSA secondary terminal.

Greater safety

The joining point where the two halves of the housing meet inside the primary bar opening is crucial to safety. Quite in accordance with CELSA's motto - safety is built into our products - the two halves of the housing are not aligned with a butt joint, instead they are made to overlap in the new AST-Line.

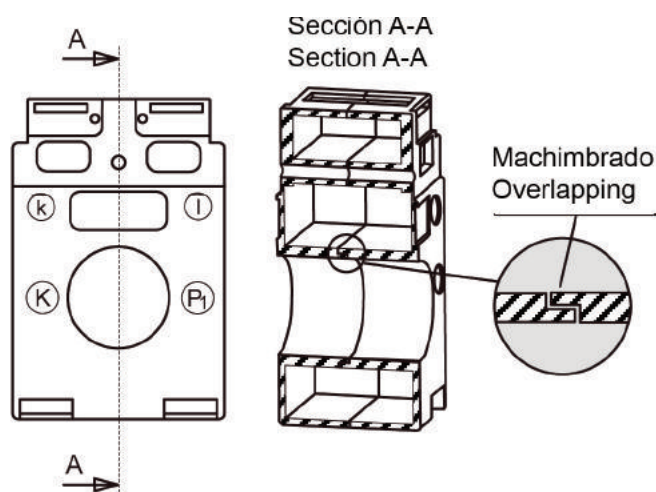

Versatility

Current transformers are frequently secured with the help of a lug through which a clamping screw fits onto the primary bar. You must have noticed what a nuisance this lug can be, for instance when you want to install the CT behind fuse switch disconnectors, fuse trips or between bar overlaps and exits.

The new current transformer of the CELSA AST-Line have their own solution to this problem. The conventional fixing device has been designed with a form-locking guide so that - if necessary - it can simply be pulled out.

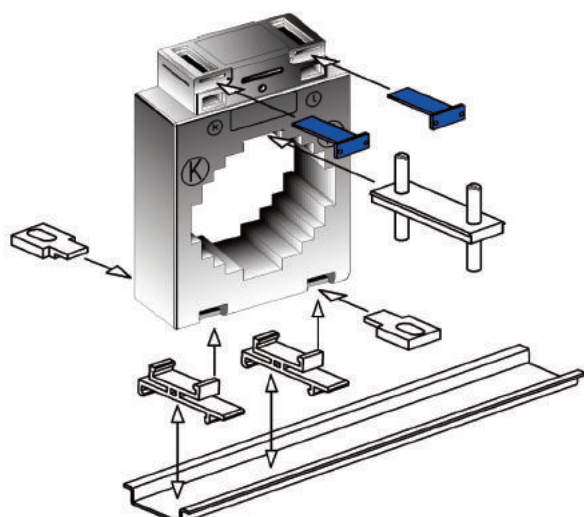

Secondary terminal openings.

The connection of secondary wire leads to their corresponding terminals is normally done by sliding them into the rectangular openings on the front or the back. If this way of connection is prohibited for instance due to blocking when mounted right behind a line of fuses the secondary wire leads equipped with clamps can also be introduced into the lateral slots for secondary terminal connection as shown

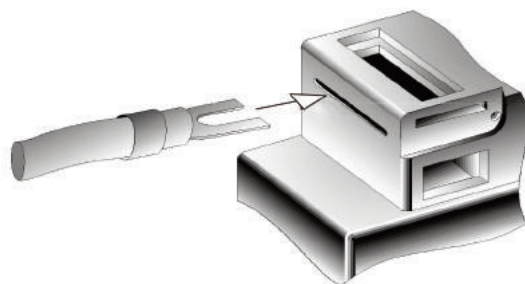

Secondary terminal

In this clamping system pressure is transmitted by means of a nut (pad) to the ends of the conductor (lift principle). The conductor is therefore loaded only under pressure and cannot be damaged by rotating components. When opened, there are two clamping spaces of 2.5mm x 4mm each in cross-section.

Thanks to our clamping system the ends of the conductors are clamped over a wide area which ensures lower contact resistance. Pressure forces of several hundred Newtons are reached. In this way conductors even with multiple, fine and extremely fine wires are so well compressed that no harmful gases can penetrate to cause corrosion. It therefore provides an extremely long-lasting connection even in aggressive industrial environment.

The plus-minus slot of the M5 (2 Nm) screws allows easy of handling. At the AST-Line both, screws and nuts are designed in such a way to prevent unintentional loosening.

Double secondary terminas for easy short-circuit

The secondary terminals are made of brass with nickel as a double terminal construction. This double construction permits a very easy short circuit of the current transformer during operation in order to carry out work on the secondary circuit.

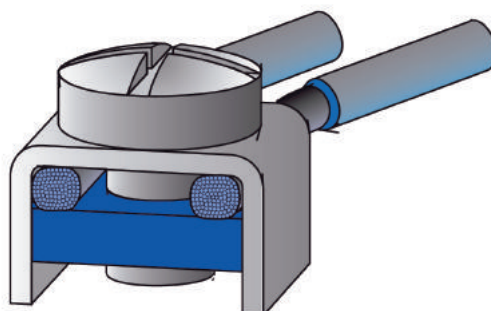

CURRENT TRANSFORMERS - AST SERIE

ASTR21

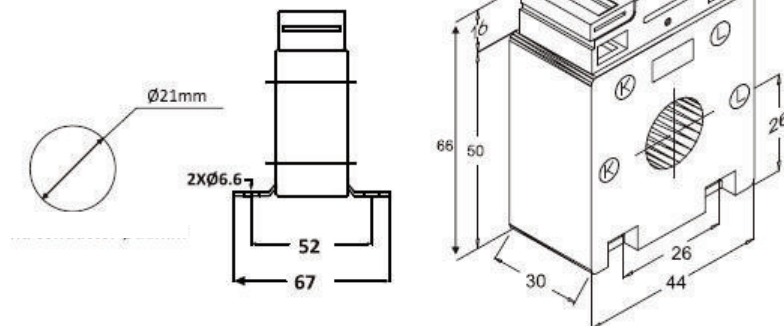

Dimensions (LxWxH): 44 x 30 x 66 mm

Round conductor: Ø 21 mm

Technical Features, Executions

Primary rated current A	sec. 5 A / Rated burdens VA	
	Class 0.5	Class 1
50	-	1.25*
60	-	1.25
75	-	1.25
80	-	1.25
100	1.5	2.5
125	2.5	3.75
150	3.75	5
200	5	5
250	5	7.5
300	5	10
400	3.75	7.5
500	3.75	7.5

* only for ammeters

Accessories:

- Mounting feet (2 pieces)

On request:

- Rated burden VA for secondary current 1A
- Other ranges, classes (0.2, 0.2S, 0.5S) or rated burden VA.

General Electrical Features

- Rated secondary current: 5A or 1A
- Frequency range 50 - 60Hz (other frequencies on request)
- Highest voltage for equipment: 720V
- Rated insulation level: 3kV/1 min
- Rated continuous thermal current: 1.2 times rated current
- Rated short-time thermal current (I_{th}): 60 times rated current
- Rated dynamic current (I_{dyn}): 2.5 times I_{th}
- Accuracy factor limit - FS < 5
- Thermal class of insulation: class E

General Mechanical Feature

- Cases of plastic, polyamide
- Cases self-extinguishing, according to UL 94 V0
- Nickel-plated secondary terminals
- Integrated secondary terminal covers

Environmental conditions

- Installation: Indoor use
- Operation temperature: - 5° C ... + 40°C
- Storage temperature: - 5° C ... + 40°C
- Altitude up to 1000 m

CURRENT TRANSFORMERS - AST SERIE

ASTMR21

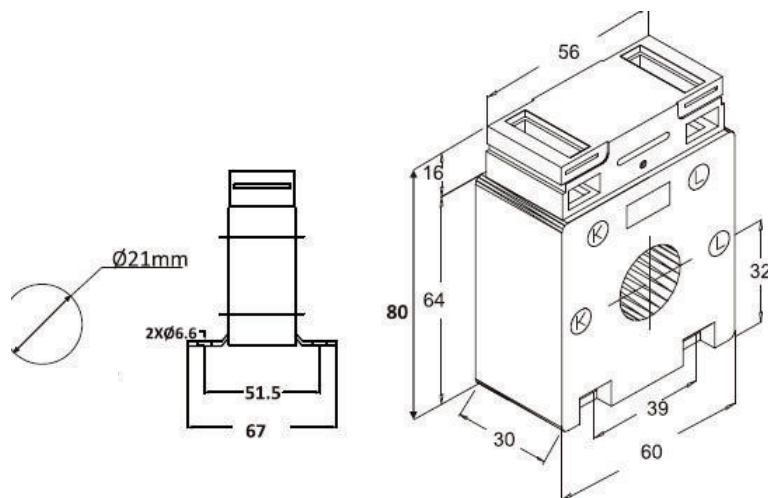

Dimensions (LxWxH): 60 x 30 x 80 mm
Round conductor: Ø 21 mm

Technical Features, Executions

Primary rated current A	sec. 5 A / Rated burdens VA	
	Class 0.5	Class 1
50	-	1
60	-	1.25
75	1.5	2.5
80	1.5	3.75
100	2.5	5
125	2.5	5
150	3.75	7.5
200	5	10
250	5	10
300	7.5	10
400	7.5	7.5
500	5	10

Accessories:

- Mounting feet (2 pieces)

On request:

- Rated burden VA for secondary current 1A
- Other ranges, classes (0.2, 0.2S, 0.5S) or rated burden VA.

General Electrical Features

- Rated secondary current: 5A or 1A
- Frequency range 50 - 60Hz (other frequencies on request)
- Highest voltage for equipment: 720V
- Rated insulation level: 3kV/1 min
- Rated continuous thermal current: 1.2 times rated current
- Rated short-time thermal current (I_{th}): 60 times rated current
- Rated dynamic current (I_{dyn}): 2.5 times I_{th}
- Accuracy factor limit - FS < 5
- Thermal class of insulation: class E

General Mechanical Feature

- Cases of plastic, polyamide
- Cases self-extinguishing, according to UL 94 V0
- Nickel-plated secondary terminals
- Integrated secondary terminal covers

Environmental conditions

- Installation: Indoor use
- Operation temperature: - 5° C ... + 40°C
- Storage temperature: - 5° C ... + 40°C
- Altitude up to 1000 m

CURRENT TRANSFORMERS - AST SERIE

AST210S



Dimensions (LxWxH):	50 x 70 x 34	mm
Round conductor:	Ø 16	mm
Primary busbar:	20 x 10	mm

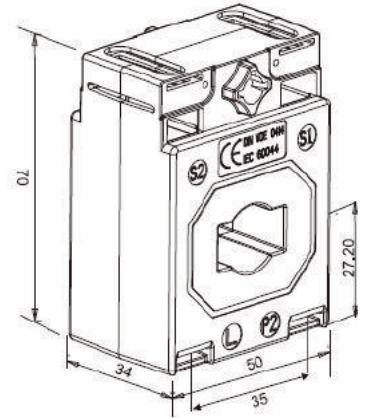
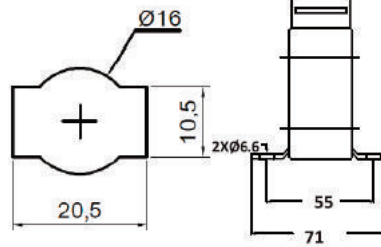

Technical Features, Executions

Primary rated current A	sec. 5 A / Rated burdens VA	
	Class 0.5	Class 1
50	-	1.25
60	-	1.25
75	1.5	1.25
80	3.75	2.5
100	2.5	2.5
125	3.75	5
150	3.75	7.5
200	5	7.5
250	5	7.5
300	5	10

Accessories (please indicate in the order):

- Mounting feet (2 pieces)
- or
- primary fixing device

On request:

- Rated burden VA for secondary current 1A
- Other ranges, classes (0.2, 0.2S, 0.5S) or rated burden VA.

General Electrical Features

- Rated secondary current: 5A or 1A
- Frequency range 50 - 60Hz (other frequencies on request)
- Highest voltage for equipment: 720V
- Rated insulation level: 3kV/1 min
- Rated continuous thermal current: 1.2 times rated current
- Rated short-time thermal current (I_{th}): 60 times rated current
- Rated dynamic current (I_{dyn}): 2.5 times I_{th}
- Accuracy factor limit - FS < 5
- Thermal class of insulation: class E

General Mechanical Feature

- Unbreakable plastic casing, polyamide
- Difficult to inflame, according to UL 94 V0 and selfextinguishing
- Nickel-plated secondary terminals with plus minus screws (2 Nm)
- Integrated secondary terminal covers

Environmental conditions

- Installation: Indoor use
- Operation temperature: - 5° C ... + 40°C
- Storage temperature: - 5° C ... + 40°C
- Altitude up to 1000 m

CURRENT TRANSFORMERS - AST SERIE

AST255S

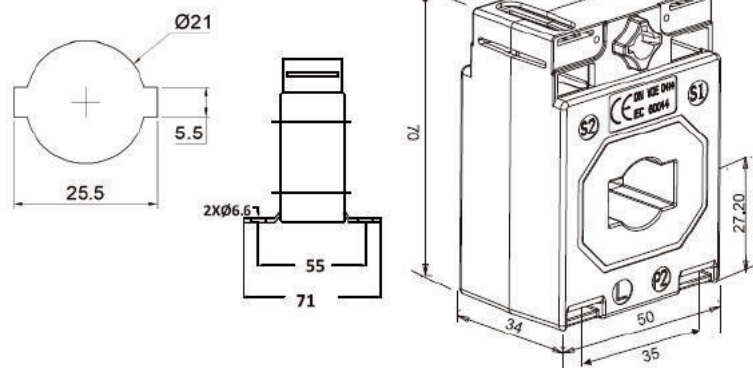

Dimensions (LxWxH):	50 x 70 x 34	mm
Round conductor:	Ø 21	mm
Primary busbar:	25 x 5	mm

Technical Features, Executions

Primary rated current A	sec. 5 A / Rated burdens VA	
	Class 0.5	Class 1
50	-	1.25
60	-	1.25
75	-	1.5
80	-	3.75
100	3.75	5
125	3.75	5
150	3.75	7.5
200	5	7.5
250	5	10
300	5	10

Accessories:

- Mounting feet (2 pieces)

On request:

- Rated burden VA for secondary current 1A
- Other ranges, classes (0.2, 0.2S, 0.5S) or rated burden VA.

General Electrical Features

- Rated secondary current: 5A or 1A
- Frequency range 50 - 60Hz (other frequencies on request)
- Highest voltage for equipment: 720V
- Rated insulation level: 3kV/1 min
- Rated continuous thermal current: 1.2 times rated current
- Rated short-time thermal current (I_{th}): 60 times rated current
- Rated dynamic current (I_{dyn}): 2.5 times I_{th}
- Accuracy factor limit - FS < 5
- Thermal class of insulation: class E

General Mechanical Feature

- Cases of plastic, polyamide
- Cases self-extinguishing, according to UL 94 V0
- Nickel-plated secondary terminals
- Integrated secondary terminal covers

Environmental conditions

- Installation: Indoor use
- Operation temperature: - 5° C ... + 40°C
- Storage temperature: - 5° C ... + 40°C
- Altitude up to 1000 m

CURRENT TRANSFORMERS - AST SERIE

AST310S

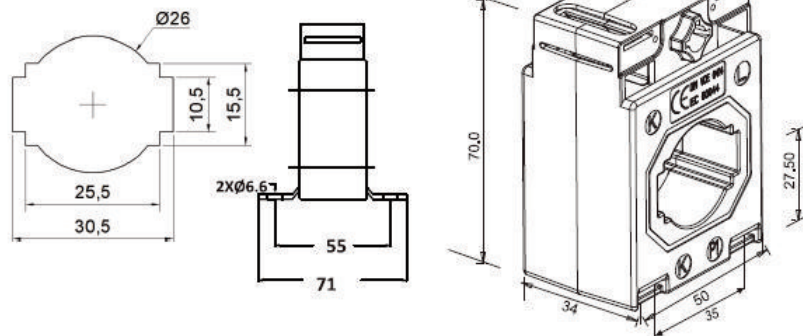
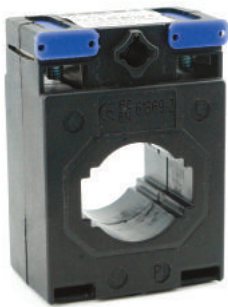

Dimensions (LxWxH):	50 x 70 x 34	mm
Round conductor:	Ø 26	mm
Primary busbar:	30 x 10	mm

Technical Features, Executions

Primary rated current A	sec. 5 A / Rated burdens VA	
	Class 0.5	Class 1
100	-	2.5
125	-	2.5
150	-	2.5
200	2.5	5
250	3.75	5
300	3.75	5
400	5	5
500	3.75	5

Accessories (please indicate in the order):

- Mounting feet (2 pieces)
- or
- primary fixing device

On request:

- Rated burden VA for secondary current 1A
- Other ranges, classes (0.2, 0.2S, 0.5S) or rated burden VA.

General Electrical Features

- Rated secondary current: 5A or 1A
- Frequency range 50 - 60Hz (other frequencies on request)
- Highest voltage for equipment: 720V
- Rated insulation level: 3kV/1 min
- Rated continuous thermal current: 1.2 times rated current
- Rated short-time thermal current (I_{th}): 60 times rated current
- Rated dynamic current (I_{dyn}): 2.5 times I_{th}
- Accuracy factor limit - FS < 5
- Thermal class of insulation: class E

General Mechanical Feature

- Cases of plastic, polyamide
- Cases self-extinguishing, according to UL 94 V0
- Nickel-plated secondary terminals
- Integrated secondary terminal covers

Environmental conditions

- Installation: Indoor use
- Operation temperature: - 5° C ... + 40° C
- Storage temperature: - 5° C ... + 40° C
- Altitude up to 1000 m

CURRENT TRANSFORMERS - AST SERIE

AST3R30

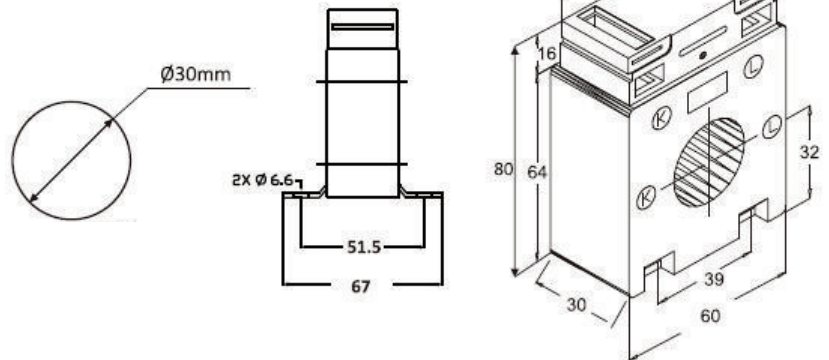

Dimensions (LxWxH):	60 x 80 x 30	mm
Round conductor:	Ø 22	mm
Primary busbar:	30 x 10	mm

Technical Features, Executions

Primary rated current A	sec. 5 A / Rated burdens VA	
	Class 0.5	Class 1
100	-	2.5
125	-	2.5
150	2.5	5
200	5	7.5
250	5	10
300	7.5	10
400	10	10
500	10	10
600	7.5	10
700	-	10
800	-	10

Accessories:

- Mounting feet (2 pieces)

On request:

- Rated burden VA for secondary current 1A
- Other ranges, classes (0.2, 0.2S, 0.5S) or rated burden VA.

General Electrical Features

- Rated secondary current: 5A or 1A
- Frequency range 50 - 60Hz (other frequencies on request)
- Highest voltage for equipment: 720V
- Rated insulation level: 3kV/1 min
- Rated continuous thermal current: 1.2 times rated current
- Rated short-time thermal current (I_{th}): 60 times rated current
- Rated dynamic current (I_{dyn}): 2.5 times I_{th}
- Accuracy factor limit - FS < 5
- Thermal class of insulation: class E

General Mechanical Feature

- Cases of plastic, polyamide
- Cases self-extinguishing, according to UL 94 V0
- Nickel-plated secondary terminals
- Integrated secondary terminal covers

Environmental conditions

- Installation: Indoor use
- Operation temperature: - 5° C ... + 40°C
- Storage temperature: - 5° C ... + 40°C
- Altitude up to 1000 m

CURRENT TRANSFORMERS - AST SERIE

AST310

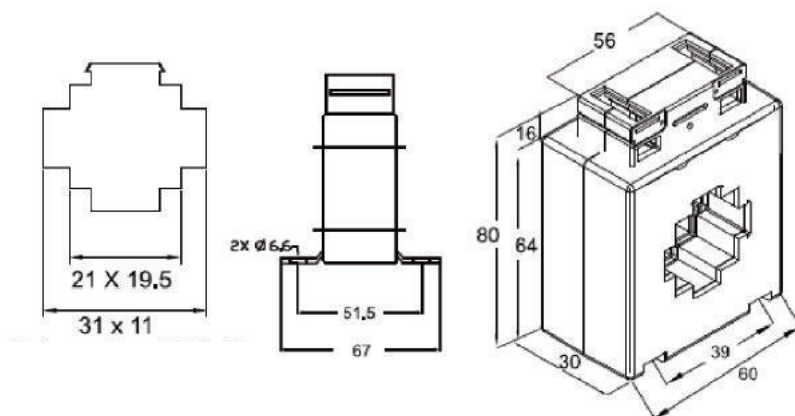

Dimensions (LxWxH):	60 x 80 x 30	mm
Round conductor:	Ø 22	mm
Primary busbar:	30 x 10	mm

Technical Features, Executions

Primary rated current A	sec. 5 A / Rated burdens VA	
	Class 0.5	Class 1
50	-	-
100	-	2.5
125	2.5	2.5
150	5	5
200	5	7.5
250	10	10
300	10	10
400	10	10
500	15	15
600	15	15
700	10	10
750	10	10
800	10	10

Accessories (please indicate in the order):

- Mounting feet (2 pieces)
- or
- primary fixing device

On request:

- Rated burden VA for secondary current 1A
- Other ranges, classes (0.2, 0.2S, 0.5S) or rated burden VA.

General Electrical Features

- Rated secondary current: 5A or 1A
- Frequency range 50 - 60Hz (other frequencies on request)
- Highest voltage for equipment: 720V
- Rated insulation level: 3kV/1 min
- Rated continuous thermal current: 1.2 times rated current
- Rated short-time thermal current (I_{th}): 60 times rated current
- Rated dynamic current (I_{dyn}): 2.5 times I_{th}
- Accuracy factor limit - FS < 5
- Thermal class of insulation: class E

General Mechanical Feature

- Cases of plastic, polyamide
- Cases self-extinguishing, according to UL 94 V0
- Nickel-plated secondary terminals
- Integrated secondary terminal covers

Environmental conditions

- Installation: Indoor use
- Operation temperature: - 5° C ... + 40°C
- Storage temperature: - 5° C ... + 40°C
- Altitude up to 1000 m

CURRENT TRANSFORMERS - AST SERIE

AST315

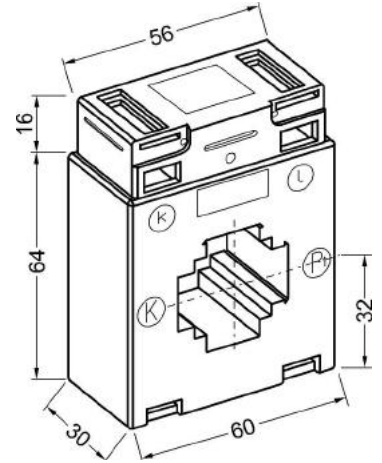
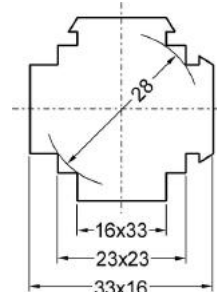

Dimensions (LxWxH):	60 x 30 x 80	mm
Round conductor:	Ø 28	mm
Primary busbar:	30 x 15	mm

Technical Features, Executions

Primary rated current A	sec. 5 A / Rated burdens VA	
	Class 0.5	Class 1
50	-	1.25 *
60	-	1.25
75	-	1.25
80	-	1.25
100	-	2.5
125	-	3.75
150	1.25	3.75
200	3.75	3.75
250	5	7.5
300	7.5	7.5
400	7.5	10
500	7.5	10
600	10	10
700	10	10
750	15	15

* clase 3

General Electrical Features

- Rated secondary current: 5A or 1A
- Frequency range 50 - 60Hz (other frequencies on request)
- Highest voltage for equipment: 720V
- Rated insulation level: 3kV/1 min
- Rated continuous thermal current: 1.2 times rated current
- Rated short-time thermal current (I_{th}): 60 times rated current
- Rated dynamic current (I_{dyn}): 2.5 times I_{th}
- Accuracy factor limit - FS < 5
- Thermal class of insulation: class E

Accessories (please indicate in the order):

- Mounting feet (2 pieces)
- or
- primary fixing device

On request:

- Rated burden VA for secondary current 1A
- Other ranges, classes (0.2, 0.2S, 0.5S) or rated burden VA.

General Mechanical Feature

- Cases of plastic, polyamide
- Cases self-extinguishing, according to UL 94 V0
- Nickel-plated secondary terminals
- Integrated secondary terminal covers

Environmental conditions

- Installation: Indoor use
- Operation temperature: - 5° C ... + 40°C
- Storage temperature: - 5° C ... + 40°C
- Altitude up to 1000 m

CURRENT TRANSFORMERS - AST SERIE

AST4R30



Dimensions (LxWxH): 68 x 87 x 40 mm
Round conductor: Ø 30 mm

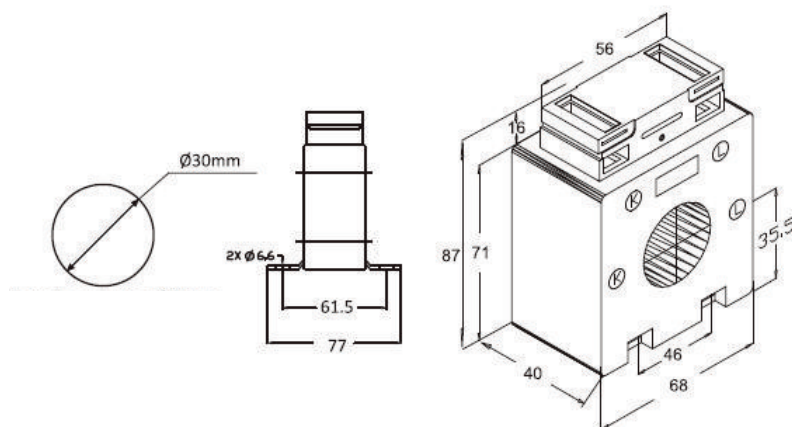

Technical Features, Executions

Primary rated current A	sec. 5 A / Rated burdens VA	
	Class 0.5	Class 1
60	-	1.25
75	-	2.5
80	-	2.5
100	2.5	5
125	3.75	5
150	3.75	10
200	5	15
250	5	15
300	10	15
400	10	15
500	15	15
600	15	15

Accessories:

- Mounting feet (2 pieces)

On request:

- Rated burden VA for secondary current 1A
- Other ranges, classes (0.2, 0.2S, 0.5S) or rated burden VA.

General Electrical Features

- Rated secondary current: 5A or 1A
- Frequency range 50 - 60Hz (other frequencies on request)
- Highest voltage for equipment: 720V
- Rated insulation level: 3kV/1 min
- Rated continuous thermal current: 1.2 times rated current
- Rated short-time thermal current (I_{th}): 60 times rated current
- Rated dynamic current (I_{dyn}): 2.5 times I_{th}
- Accuracy factor limit - FS < 5
- Thermal class of insulation: class E

General Mechanical Feature

- Cases of plastic, polyamide
- Cases self-extinguishing, according to UL 94 V0
- Nickel-plated secondary terminals
- Integrated secondary terminal covers

Environmental conditions

- Installation: Indoor use
- Operation temperature: - 5° C ... + 40°C
- Storage temperature: - 5° C ... + 40°C
- Altitude up to 1000 m

CURRENT TRANSFORMERS - AST SERIE

AST4B312



Dimensions (LxWxH): 68 x 87 x 34 mm

Round conductor: Ø 26 mm

Primary busbar: 30 x 10 mm

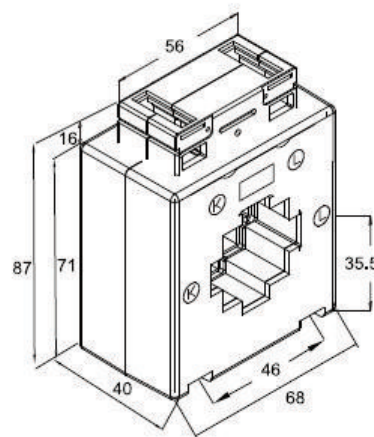
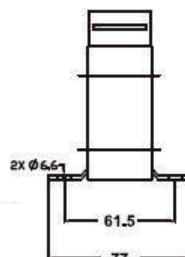
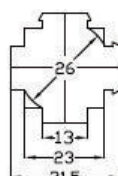

Technical Features, Executions

Primary rated current A	sec. 5 A / Rated burdens VA	
	Class 0.5	Class 1
60	-	1.25
75	-	1.5
80	-	1.5
100	-	5
125	-	5
150	5	10
200	5	10
250	5	15
300	10	15
400	10	15
500	15	15
600	15	15

Accessories (please indicate in the order):

- Mounting feet (2 pieces)

or

- primary fixing device

On request:

- Rated burden VA for secondary current 1A
- Other ranges, classes (0.2, 0.2S, 0.5S) or rated burden VA.

General Electrical Features

- Rated secondary current: 5A or 1A
- Frequency range 50 - 60Hz (other frequencies on request)
- Highest voltage for equipment: 720V
- Rated insulation level: 3kV/1 min
- Rated continuous thermal current: 1.2 times rated current
- Rated short-time thermal current (I_{th}): 60 times rated current
- Rated dynamic current (I_{dyn}): 2.5 times I_{th}
- Accuracy factor limit - FS < 5
- Thermal class of insulation: class E

General Mechanical Feature

- Cases of plastic, polyamide
- Cases self-extinguishing, according to UL 94 V0
- Nickel-plated secondary terminals
- Integrated secondary terminal covers

Environmental conditions

- Installation: Indoor use
- Operation temperature: - 5° C ... + 40°C
- Storage temperature: - 5° C ... + 40°C
- Altitude up to 1000 m

CURRENT TRANSFORMERS - AST SERIE

AST5R30

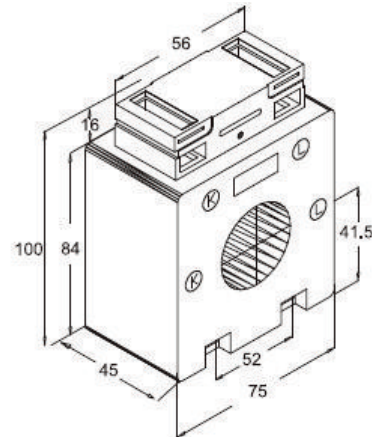
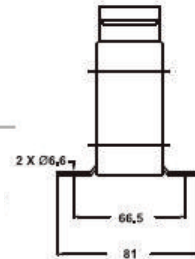
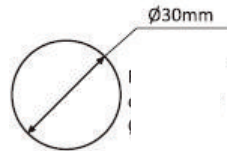

Dimensions (LxWxH): 75 x 100 x 45 mm
Round conductor: Ø 30 mm

Technical Features, Executions

Primary rated current A	sec. 5 A / Rated burdens VA	
	Class 0.5	Class 1
50	-	1
60	-	1.25
75	-	2.5
80	-	2.5
100	-	7.5
125	3.75	10
150	5	15
200	10	15
250	10	15
300	10	15
400	10	15
500	10	15
600	10	15

Accessories:

- Mounting feet (2 pieces)

On request:

- Rated burden VA for secondary current 1A
- Other ranges, classes (0.2, 0.2S, 0.5S) or rated burden VA.

General Electrical Features

- Rated secondary current: 5A or 1A
- Frequency range 50 - 60Hz (other frequencies on request)
- Highest voltage for equipment: 720V
- Rated insulation level: 3kV/1 min
- Rated continuous thermal current: 1.2 times rated current
- Rated short-time thermal current (I_{th}): 60 times rated current
- Rated dynamic current (I_{dyn}): 2.5 times I_{th}
- Accuracy factor limit - FS < 5
- Thermal class of insulation: class E

General Mechanical Feature

- Cases of plastic, polyamide
- Cases self-extinguishing, according to UL 94 V0
- Nickel-plated secondary terminals
- Integrated secondary terminal covers

Environmental conditions

- Installation: Indoor use
- Operation temperature: - 5° C ... + 40° C
- Storage temperature: - 5° C ... + 40° C
- Altitude up to 1000 m

CURRENT TRANSFORMERS - AST SERIE

AST5B312

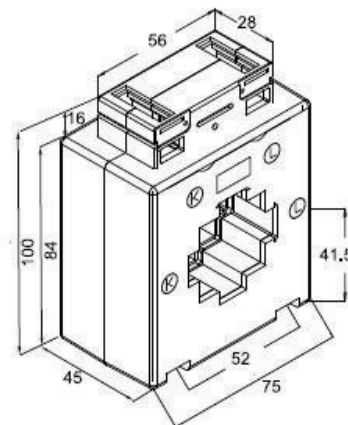
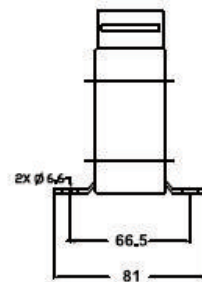
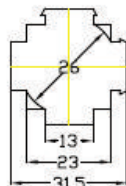

Dimensions (LxWxH): 75 x 100 x 45 mm

Round conductor: Ø 26 mm

Primary busbar: 30 x 10 mm

Technical Features, Executions

Primary rated current A	sec. 5 A / Rated burdens VA	
	Class 0.5	Class 1
50	-	1.25
60	-	1.5
75	-	2.5
80	-	5
100	3.75	7.5
125	5	10
150	7.5	15
200	10	15
250	5	15
300	10	15
400	10	15
500	10	15
600	10	15

Accessories (please indicate in the order):

- Mounting feet (2 pieces)

or

- primary fixing device

On request:

- Rated burden VA for secondary current 1A
- Other ranges, classes (0.2, 0.2S, 0.5S) or rated burden VA.

General Electrical Features

- Rated secondary current: 5A or 1A
- Frequency range 50 - 60Hz (other frequencies on request)
- Highest voltage for equipment: 720V
- Rated insulation level: 3kV/1 min
- Rated continuous thermal current: 1.2 times rated current
- Rated short-time thermal current (I_{th}): 60 times rated current
- Rated dynamic current (I_{dyn}): 2.5 times I_{th}
- Accuracy factor limit - FS < 5
- Thermal class of insulation: class E

General Mechanical Feature

- Cases of plastic, polyamide
- Cases self-extinguishing, according to UL 94 V0
- Nickel-plated secondary terminals
- Integrated secondary terminal covers

Environmental conditions

- Installation: Indoor use
- Operation temperature: - 5° C ... + 40° C
- Storage temperature: - 5° C ... + 40° C
- Altitude up to 1000 m

CURRENT TRANSFORMERS - AST SERIE

AST4R40

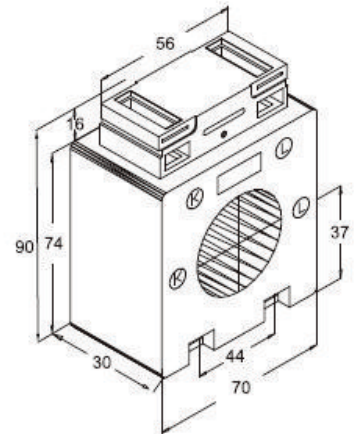
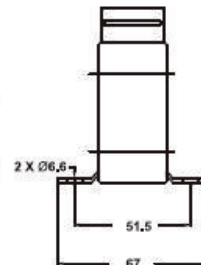
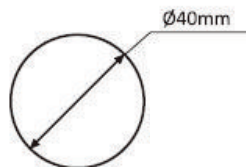

Dimensions (LxWxH):	70 x 90 30	mm
Round conductor:	Ø 40	mm

Technical Features, Executions

Primary rated current A	sec. 5 A / Rated burdens VA	
	Class 0.5	Class 1
150	-	1.5
200	1.5	5
250	2.5	7.5
300	5	75
400	10	10
500	10	10
600	-	10
750	-	10
800	-	10
1000	-	10

Accessories:

- Mounting feet (2 pieces)

On request:

- Rated burden VA for secondary current 1A
- Other ranges, classes (0.2, 0.2S, 0.5S) or rated burden VA.

General Electrical Features

- Rated secondary current: 5A or 1A
- Frequency range 50 - 60Hz (other frequencies on request)
- Highest voltage for equipment: 720V
- Rated insulation level: 3kV/1 min
- Rated continuous thermal current: 1.2 times rated current
- Rated short-time thermal current (I_{th}): 60 times rated current
- Rated dynamic current (I_{dyn}): 2.5 times I_{th}
- Accuracy factor limit - FS < 5
- Thermal class of insulation: class E

General Mechanical Feature

- Cases of plastic, polyamide
- Cases self-extinguishing, according to UL 94 V0
- Nickel-plated secondary terminals
- Integrated secondary terminal covers

Environmental conditions

- Installation: Indoor use
- Operation temperature: - 5° C ... + 40°C
- Storage temperature: - 5° C ... + 40°C
- Altitude up to 1000 m

CURRENT TRANSFORMERS - AST SERIE

AST412

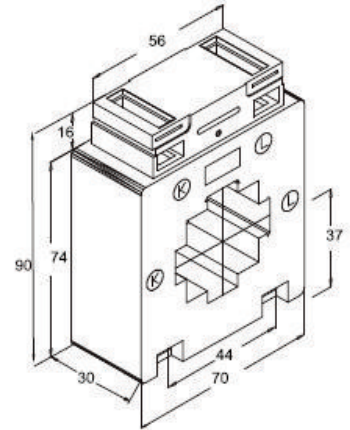
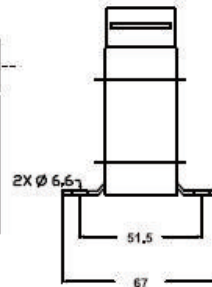
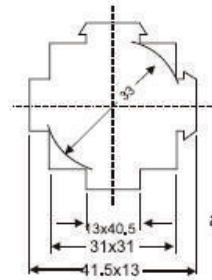

Dimensions (LxWxH):	70 x 90 x 30	mm
Round conductor:	Ø 33	mm
Primary busbar:	40 x 13	mm
	2 x 30 x 10	mm

Technical Features, Executions

Primary rated current A	sec. 5 A / Rated burdens VA	
	Class 0.5	Class 1
100	-	1.25
125	1.25	1.25
150	2.5	5
200	3.75	5
250	5	7.5
300	5	7.5
400	7.5	10
500	7.5	10
600	15	15
750	10	15
800	10	15
1000	10	20

Accessories (please indicate in the order):

- Mounting feet (2 pieces)

or

- primary fixing device

On request:

- Rated burden VA for secondary current 1A
- Other ranges, classes (0.2, 0.2S, 0.5S) or rated burden VA.

General Electrical Features

- Rated secondary current: 5A or 1A
- Frequency range 50 - 60Hz (other frequencies on request)
- Highest voltage for equipment: 720V
- Rated insulation level: 3kV/1 min
- Rated continuous thermal current: 1.2 times rated current
- Rated short-time thermal current (I_{th}): 60 times rated current
- Rated dynamic current (I_{dyn}): 2.5 times I_{th}
- Accuracy factor limit - FS < 5
- Thermal class of insulation: class E

General Mechanical Feature

- Cases of plastic, polyamide
- Cases self-extinguishing, according to UL 94 V0
- Nickel-plated secondary terminals
- Integrated secondary terminal covers

Environmental conditions

- Installation: Indoor use
- Operation temperature: - 5° C ... + 40°C
- Storage temperature: - 5° C ... + 40°C
- Altitude up to 1000 m

CURRENT TRANSFORMERS - AST SERIE

AST5B412

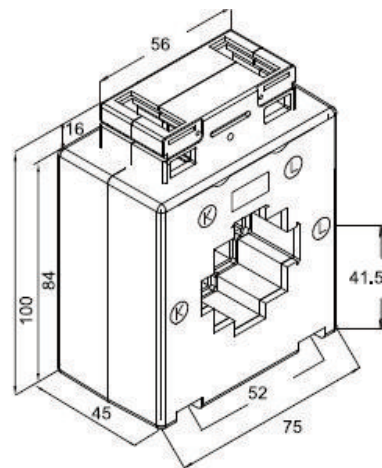
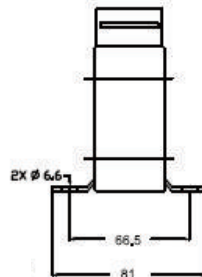
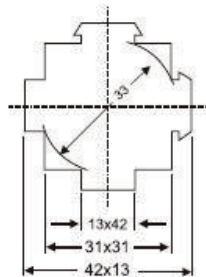

Dimensions (LxWxH):	75 x 100 x 45	mm
Round conductor:	Ø 33	mm
Primary busbar:	40 x 13	mm
	2 x 30 x 10	mm

Technical Features, Executions

Primary rated current A	sec. 5 A / Rated burdens VA	
	Class 0.5	Class 1
75	-	1.5
80	-	1.5
100	2.5	3.75
125	2.5	5
150	5	10
200	5	15
250	10	15
300	10	15
400	10	15
500	10	15
600	10	15

Accessories (please indicate in the order):

- Mounting feet (2 pieces)

or

- primary fixing device

On request:

- Rated burden VA for secondary current 1A
- Other ranges, classes (0.2, 0.2S, 0.5S) or rated burden VA.

General Electrical Features

- Rated secondary current: 5A or 1A
- Frequency range 50 - 60Hz (other frequencies on request)
- Highest voltage for equipment: 720V
- Rated insulation level: 3kV/1 min
- Rated continuous thermal current: 1.2 times rated current
- Rated short-time thermal current (I_{th}): 60 times rated current
- Rated dynamic current (I_{dyn}): 2.5 times I_{th}
- Accuracy factor limit - FS < 5
- Thermal class of insulation: class E

General Mechanical Feature

- Cases of plastic, polyamide
- Cases self-extinguishing, according to UL 94 V0
- Nickel-plated secondary terminals
- Integrated secondary terminal covers

Environmental conditions

- Installation: Indoor use
- Operation temperature: - 5° C ... + 40°C
- Storage temperature: - 5° C ... + 40°C
- Altitude up to 1000 m

CURRENT TRANSFORMERS - AST SERIE

AST5R50

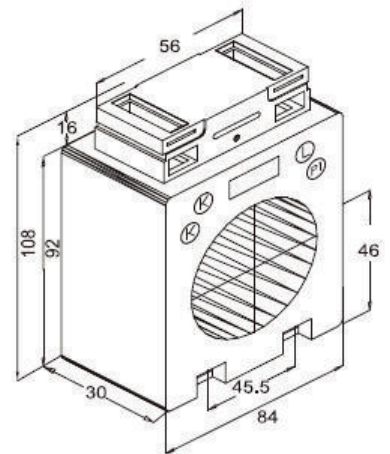
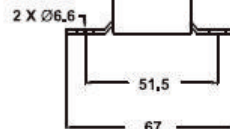
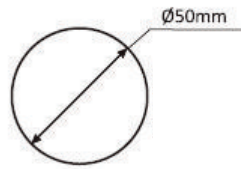

Dimensions (LxWxH): 84 x 108 x 30 mm

Round conductor: Ø 50 mm

Technical Features, Executions

Primary rated current A	sec. 5 A / Rated burdens VA	
	Class 0.5	Class 1
100	-	1
125	-	1.25
150	-	2.5
200	-	5
250	2.5	7.5
300	5	15
400	10	15
500	10	15
600	10	15
750	15	15
800	15	15
1000	15	15
1250	15	15
1500	-	15

Accessories:

- Mounting feet (2 pieces)

On request:

- Rated burden VA for secondary current 1A
- Other ranges, classes (0.2, 0.2S, 0.5S) or rated burden VA.

General Electrical Features

- Rated secondary current: 5A or 1A
- Frequency range 50 - 60Hz (other frequencies on request)
- Highest voltage for equipment: 720V
- Rated insulation level: 3kV/1 min
- Rated continuous thermal current: 1.2 times rated current
- Rated short-time thermal current (I_{th}): 60 times rated current
- Rated dynamic current (I_{dyn}): 2.5 times I_{th}
- Accuracy factor limit - FS < 5
- Thermal class of insulation: class E

General Mechanical Feature

- Cases of plastic, polyamide
- Cases self-extinguishing, according to UL 94 V0
- Nickel-plated secondary terminals
- Integrated secondary terminal covers

Environmental conditions

- Installation: Indoor use
- Operation temperature: - 5° C ... + 40° C
- Storage temperature: - 5° C ... + 40° C
- Altitude up to 1000 m

CURRENT TRANSFORMERS - AST SERIE

AST512

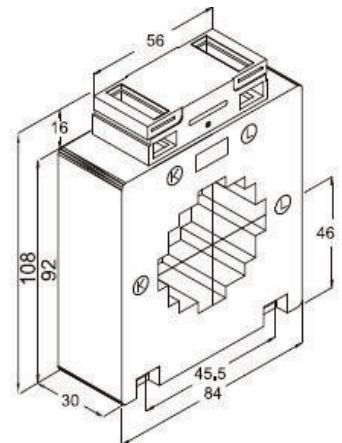
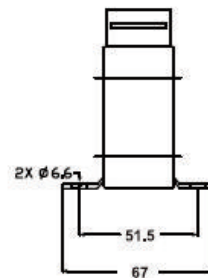
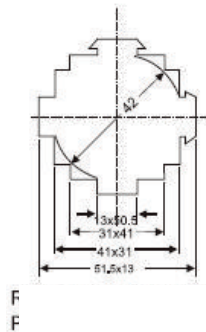

Dimensions (LxWxH):	84 x 10 x 30	mm
Round conductor:	Ø 42	mm
Primary busbar:	50 x 13	mm
	2 x 40 x 10	mm

Technical Features, Executions

Primary rated current A	sec. 5 A / Rated burdens VA	
	Class 0.5	Class 1
100	-	1.25
125	-	1.25
150	-	1.25
200	-	5
250	2.5	7.5
300	5	10
400	7.5	15
500	15	15
600	5	20
750	15	10
800	15	15
1000	15	20
1250	15	20
1500	-	15

Accessories (please indicate in the order):

- Mounting feet (2 pieces)

or

- primary fixing device

On request:

- Rated burden VA for secondary current 1A
- Other ranges, classes (0.2, 0.2S, 0.5S) or rated burden VA.

General Electrical Features

- Rated secondary current: 5A or 1A
- Frequency range 50 - 60Hz (other frequencies on request)
- Highest voltage for equipment: 720V
- Rated insulation level: 3kV/1 min
- Rated continuous thermal current: 1.2 times rated current
- Rated short-time thermal current (I_{th}): 60 times rated current
- Rated dynamic current (I_{dyn}): 2.5 times I_{th}
- Accuracy factor limit - FS < 5
- Thermal class of insulation: class E

General Mechanical Feature

- Cases of plastic, polyamide
- Cases self-extinguishing, according to UL 94 V0
- Nickel-plated secondary terminals
- Integrated secondary terminal covers

Environmental conditions

- Installation: Indoor use
- Operation temperature: - 5° C ... + 40°C
- Storage temperature: - 5° C ... + 40°C
- Altitude up to 1000 m

CURRENT TRANSFORMERS - AST SERIE

AST6R65

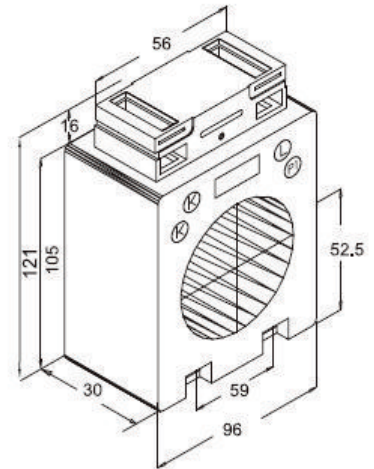
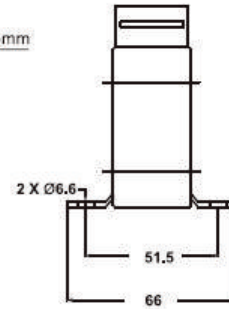
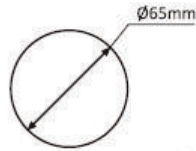

Dimensions (LxWxH): 96 x 121 x 30 mm

Round conductor: Ø 65 mm

Technical Features, Executions

Primary rated current A	sec. 5 A / Rated burdens VA	
	Class 0.5	Class 1
200	-	2.5
250	-	5
300	5	5
400	5	10
500	10	15
600	15	15
750	15	15
800	15	15
1000	15	15
1250	15	15
1500	15	15
1600	15	15
2000	-	15

Accessories:

- Mounting feet (2 pieces)

On request:

- Rated burden VA for secondary current 1A
- Other ranges, classes (0.2, 0.2S, 0.5S) or rated burden VA.

General Electrical Features

- Rated secondary current: 5A or 1A
- Frequency range 50 - 60Hz (other frequencies on request)
- Highest voltage for equipment: 720V
- Rated insulation level: 3kV/1 min
- Rated continuous thermal current: 1.2 times rated current
- Rated short-time thermal current (I_{th}): 60 times rated current
- Rated dynamic current (I_{dyn}): 2.5 times I_{th}
- Accuracy factor limit - FS < 5
- Thermal class of insulation: class E

General Mechanical Feature

- Cases of plastic, polyamide
- Cases self-extinguishing, according to UL 94 V0
- Nickel-plated secondary terminals
- Integrated secondary terminal covers

Environmental conditions

- Installation: Indoor use
- Operation temperature: - 5° C ... + 40°C
- Storage temperature: - 5° C ... + 40°C
- Altitude up to 1000 m

CURRENT TRANSFORMERS - AST SERIE

AST615

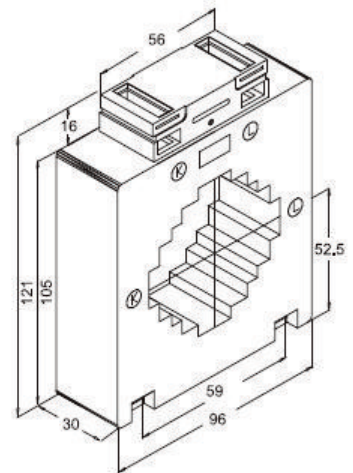
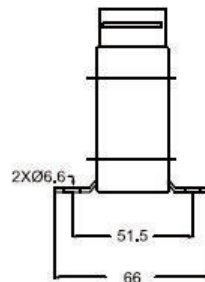
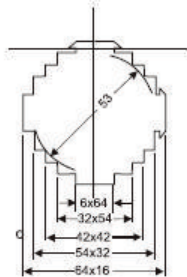

Dimensions (LxWxH):	96 x 121 x 30	mm
Round conductor:	Ø 53	mm
Primary busbar:	60 x 15	mm
	2 x 50 x 10	mm
	40 x 40	mm

Technical Features, Executions

Primary rated current A	sec. 5 A / Rated burdens VA	
	Class 0.5	Class 1
200	-	2.5
250	2.5	5
300	2.5	5
400	5	15
500	7.5	15
600	10	15
750	15	15
800	15	15
1000	15	20
1250	15	15
1500	15	15
1600	15	20
2000	30	15

Accessories (please indicate in the order):

- Mounting feet (2 pieces)

or

- primary fixing device

On request:

- Rated burden VA for secondary current 1A
- Other ranges, classes (0.2, 0.2S, 0.5S) or rated burden VA.

General Electrical Features

- Rated secondary current: 5A or 1A
- Frequency range 50 - 60Hz (other frequencies on request)
- Highest voltage for equipment: 720V
- Rated insulation level: 3kV/1 min
- Rated continuous thermal current: 1.2 times rated current
- Rated short-time thermal current (I_{th}): 60 times rated current
- Rated dynamic current (I_{dyn}): 2.5 times I_{th}
- Accuracy factor limit - FS < 5
- Thermal class of insulation: class E

General Mechanical Feature

- Cases of plastic, polyamide
- Cases self-extinguishing, according to UL 94 V0
- Nickel-plated secondary terminals
- Integrated secondary terminal covers

Environmental conditions

- Installation: Indoor use
- Operation temperature: - 5° C ... + 40°C
- Storage temperature: - 5° C ... + 40°C
- Altitude up to 1000 m

CURRENT TRANSFORMERS - AST SERIE

AST615.5



Dimensions (LxWxH):	84 x 108 x 30	mm
Round conductor:	Ø 52	mm
Primary busbar:	60 x 15	mm
	2 x 50 x 10	mm
	40 x 40	mm

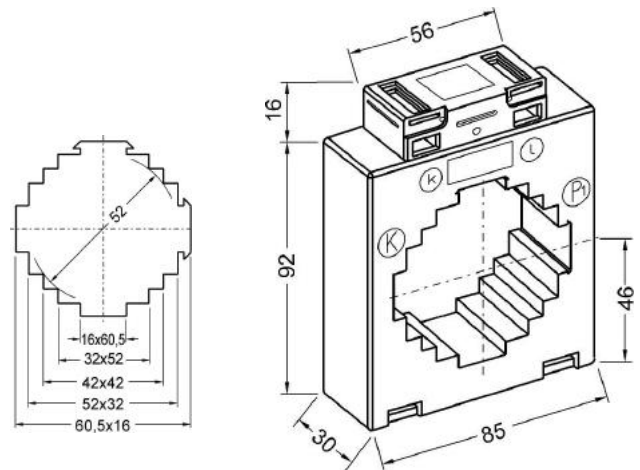

Technical Features, Executions

Primary rated current A	sec. 5 A / Rated burdens VA	
	Class 0.5	Class 1
200	1.25	3.75
250	2.5	5
300	3.75	5
400	5	7.5
500	10	10
600	10	10
750	15	15
800	15	15
1000	15	15
1250	20	20
1500	20	25
1600	25	25

Accessories (please indicate in the order):

- Mounting feet (2 pieces)

or

- primary fixing device

On request:

- Rated burden VA for secondary current 1A
- Other ranges, classes (0.2, 0.2S, 0.5S) or rated burden VA.

General Electrical Features

- Rated secondary current: 5A or 1A
- Frequency range 50 - 60Hz (other frequencies on request)
- Highest voltage for equipment: 720V
- Rated insulation level: 3kV/1 min
- Rated continuous thermal current: 1.2 times rated current
- Rated short-time thermal current (I_{th}): 60 times rated current
- Rated dynamic current (I_{dyn}): 2.5 times I_{th}
- Accuracy factor limit - FS < 5
- Thermal class of insulation: class E

General Mechanical Feature

- Cases of plastic, polyamide
- Cases self-extinguishing, according to UL 94 V0
- Nickel-plated secondary terminals
- Integrated secondary terminal covers

Environmental conditions

- Installation: Indoor use
- Operation temperature: - 5° C ... + 40°C
- Storage temperature: - 5° C ... + 40°C
- Altitude up to 1000 m

CURRENT TRANSFORMERS - AST SERIE

AST640

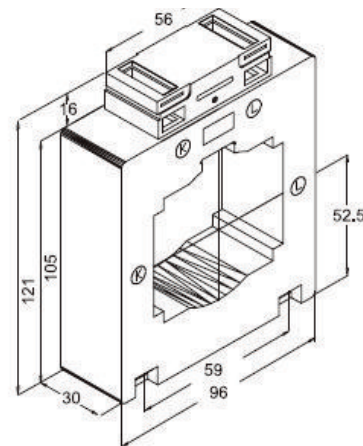
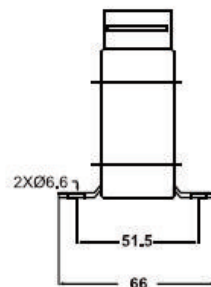
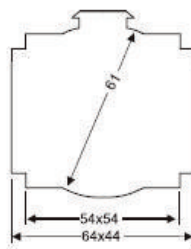
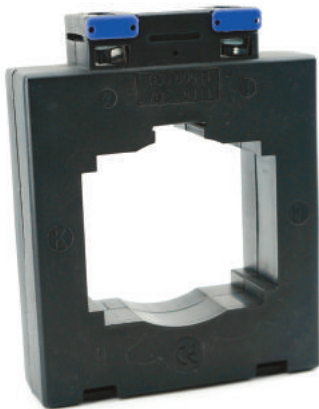

Dimensions (LxWxH): 96 x 121 x 30 mm

Round conductor: Ø 61 mm

Primary busbar:
60 x 40 mm
3 x 60 x 10 mm
3 x 40 x 10 mm

Technical Features, Executions

Primary rated current A	sec. 5 A / Rated burdens VA	
	Class 0.5	Class 1
200	-	2.5
250	-	5
300	5	5
400	3.75	7.5
500	5	10
600	10	15
750	10	15
800	15	15
1000	15	15
1250	15	15
1500	15	15
1600	15	20
2000	-	15

Accessories (please indicate in the order):

- Mounting feet (2 pieces)

or

- primary fixing device

On request:

- Rated burden VA for secondary current 1A
- Other ranges, classes (0.2, 0.2S, 0.5S) or rated burden VA.

General Electrical Features

- Rated secondary current: 5A or 1A
- Frequency range 50 - 60Hz (other frequencies on request)
- Highest voltage for equipment: 720V
- Rated insulation level: 3kV/1 min
- Rated continuous thermal current: 1.2 times rated current
- Rated short-time thermal current (I_{th}): 60 times rated current
- Rated dynamic current (I_{dyn}): 2.5 times I_{th}
- Accuracy factor limit - FS < 5
- Thermal class of insulation: class E

General Mechanical Feature

- Cases of plastic, polyamide
- Cases self-extinguishing, according to UL 94 V0
- Nickel-plated secondary terminals
- Integrated secondary terminal covers

Environmental conditions

- Installation: Indoor use
- Operation temperature: - 5° C ... + 40°C
- Storage temperature: - 5° C ... + 40°C
- Altitude up to 1000 m

CURRENT TRANSFORMERS - AST SERIE

AST815

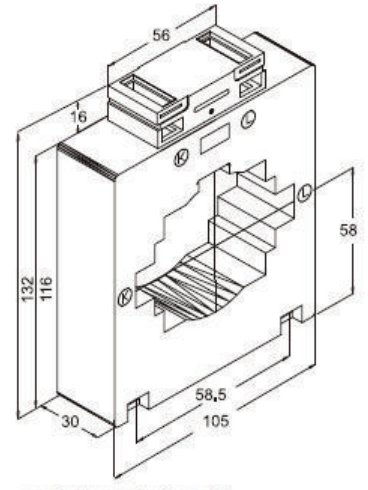
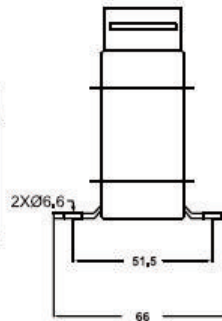
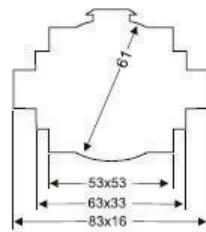

Dimensions (LxWxH): 105 x 132 x 30 mm

Round conductor: Ø 61 mm

Primary busbar: 80 x 15 mm
2 x 60 x 10 mm
3 x 50 x 10 mm

Technical Features, Executions

Primary rated current A	sec. 5 A / Rated burdens VA	
	Class 0.5	Class 1
400	-	5
500	-	7.5
600	5	10
750	5	10
800	10	10
1000	15	15
1250	7.5	15
1500	10	10
1600	10	15
2000	10	10

Accessories (please indicate in the order):

- Mounting feet (2 pieces)

or

- primary fixing device

On request:

- Rated burden VA for secondary current 1A
- Other ranges, classes (0.2, 0.2S, 0.5S) or rated burden VA.

General Electrical Features

- Rated secondary current: 5A or 1A
- Frequency range 50 - 60Hz (other frequencies on request)
- Highest voltage for equipment: 720V
- Rated insulation level: 3kV/1 min
- Rated continuous thermal current: 1.2 times rated current
- Rated short-time thermal current (I_{th}): 60 times rated current
- Rated dynamic current (I_{dyn}): 2.5 times I_{th}
- Accuracy factor limit - FS < 5
- Thermal class of insulation: class E

General Mechanical Feature

- Cases of plastic, polyamide
- Cases self-extinguishing, according to UL 94 V0
- Nickel-plated secondary terminals
- Integrated secondary terminal covers

Environmental conditions

- Installation: Indoor use
- Operation temperature: - 5° C ... + 40°C
- Storage temperature: - 5° C ... + 40°C
- Altitude up to 1000 m

CURRENT TRANSFORMERS - AST SERIE

AST830 - 830V

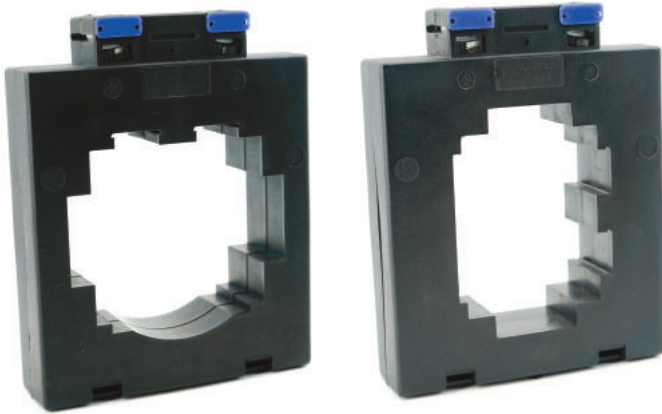

Dimensions (LxWxH):	105 x 132 x 30	mm
Round conductor:	Ø 70	mm
Primary busbar:	2 x 80 x 10	mm
AST830	60 x 60	mm
AST830V	60 x 50	mm

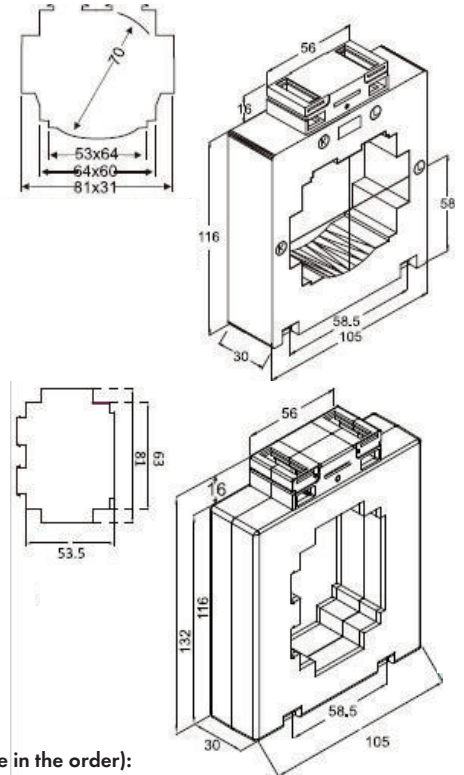

Technical Features, Executions

Primary rated current A	sec. 5 A / Rated burdens VA	
	Class 0.5	Class 1
400	-	3.75
500	-	7.5
600	5	10
750	5	10
800	7.5	7.5
1000	10	10
1250	10	15
1500	15	15
1600	15	15

Accessories (please indicate in the order):

- Mounting feet (2 pieces)

or

- primary fixing device

On request:

- Rated burden VA for secondary current 1A
- Other ranges, classes (0.2, 0.2S, 0.5S) or rated burden VA.

General Electrical Features

- Rated secondary current: 5A or 1A
- Frequency range 50 - 60Hz (other frequencies on request)
- Highest voltage for equipment: 720V
- Rated insulation level: 3kV/1 min
- Rated continuous thermal current: 1.2 times rated current
- Rated short-time thermal current (I_{th}): 60 times rated current
- Rated dynamic current (I_{dyn}): 2.5 times I_{th}
- Accuracy factor limit - FS < 5
- Thermal class of insulation: class E

General Mechanical Feature

- Cases of plastic, polyamide
- Cases self-extinguishing, according to UL 94 V0
- Nickel-plated secondary terminals
- Integrated secondary terminal covers

Environmental conditions

- Installation: Indoor use
- Operation temperature: - 5° C ... + 40°C
- Storage temperature: - 5° C ... + 40°C
- Altitude up to 1000 m

CURRENT TRANSFORMERS - AST SERIE

AST1030 - 1030V

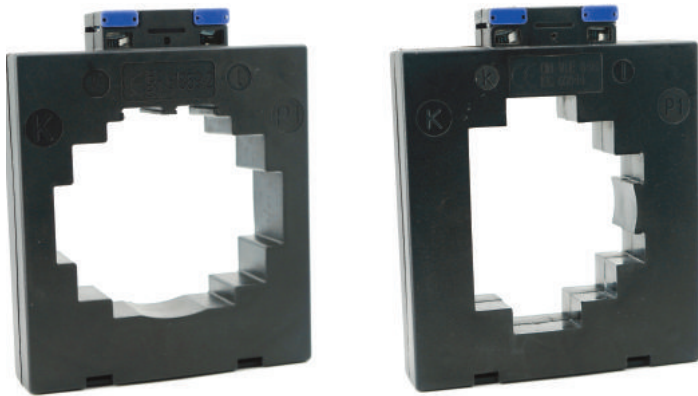

Dimensions (LxWxH):	131 x 144 x 30	mm
Round conductor:	Ø 85	mm
Primary busbar:	2 x 100 x 10 75 x 60	mm

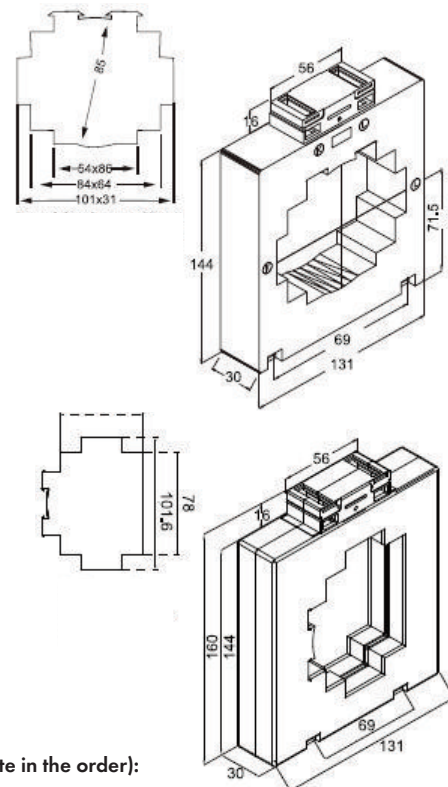

Technical Features, Executions

Primary rated current A	sec. 5 A / Rated burdens VA	
	Class 0.5	Class 1
600	-	10
750	5	10
800	7.5	10
1000	10	15
1250	15	15
1500	15	15
1600	15	15
2000	15	15
2500	15	30
3000	15	15
3200	15	15

Accessories (please indicate in the order):

- Mounting feet (2 pieces)

or

- primary fixing device

On request:

- Rated burden VA for secondary current 1A
- Other ranges, classes (0.2, 0.2S, 0.5S) or rated burden VA.

General Electrical Features

- Rated secondary current: 5A or 1A
- Frequency range 50 - 60Hz (other frequencies on request)
- Highest voltage for equipment: 720V
- Rated insulation level: 3kV/1 min
- Rated continuous thermal current: 1.2 times rated current
- Rated short-time thermal current (I_{th}): 60 times rated current
- Rated dynamic current (I_{dyn}): 2.5 times I_{th}
- Accuracy factor limit - FS < 5
- Thermal class of insulation: class E

General Mechanical Feature

- Cases of plastic, polyamide
- Cases self-extinguishing, according to UL 94 V0
- Nickel-plated secondary terminals
- Integrated secondary terminal covers

Environmental conditions

- Installation: Indoor use
- Operation temperature: - 5° C ... + 40° C
- Storage temperature: - 5° C ... + 40° C
- Altitude up to 1000 m

CURRENT TRANSFORMERS - AST SERIE

AST1056

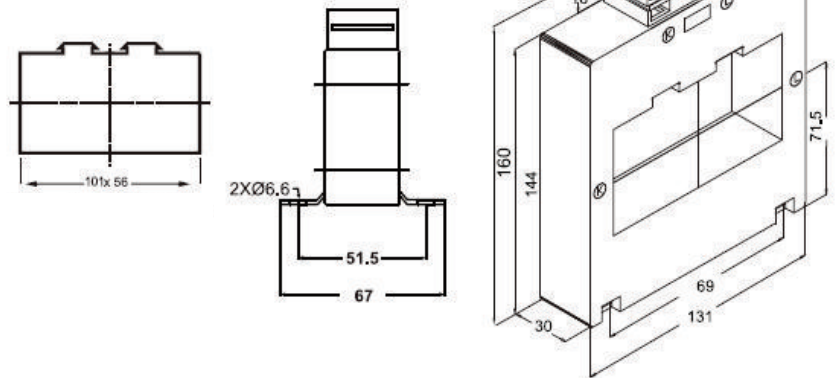

Dimensions (LxWxH):	131 x 160 x 30	mm
Round conductor:	Ø 61	mm
Primary busbar:	105 x 60	mm

Technical Features, Executions

Primary rated current A	sec. 5 A / Rated burdens VA	
	Class 0.5	Class 1
600	-	10
750	5	10
800	7.5	10
1000	10	10
1250	15	15
1500	15	15
1600	15	15
2000	15	25
2500	20	30
3000	25	30
3200	10	30

Accessories (please indicate in the order):

- Mounting feet (2 pieces)
- or
- primary fixing device

On request:

- Rated burden VA for secondary current 1A
- Other ranges, classes (0.2, 0.2S, 0.5S) or rated burden VA.

General Electrical Features

- Rated secondary current: 5A or 1A
- Frequency range 50 - 60Hz (other frequencies on request)
- Highest voltage for equipment: 720V
- Rated insulation level: 3kV/1 min
- Rated continuous thermal current: 1.2 times rated current
- Rated short-time thermal current (I_{th}): 60 times rated current
- Rated dynamic current (I_{dyn}): 2.5 times I_{th}
- Accuracy factor limit - FS < 5
- Thermal class of insulation: class E

General Mechanical Feature

- Cases of plastic, polyamide
- Cases self-extinguishing, according to UL 94 V0
- Nickel-plated secondary terminals
- Integrated secondary terminal covers

Environmental conditions

- Installation: Indoor use
- Operation temperature: - 5° C ... + 40°C
- Storage temperature: - 5° C ... + 40°C
- Altitude up to 1000 m

CURRENT TRANSFORMERS - AST SERIE

AST1234



Dimensions (LxWxH): 159 x 188 x 30 mm

Round conductor: Ø 96 mm

Primary busbar: 2 x 120 x 10 mm

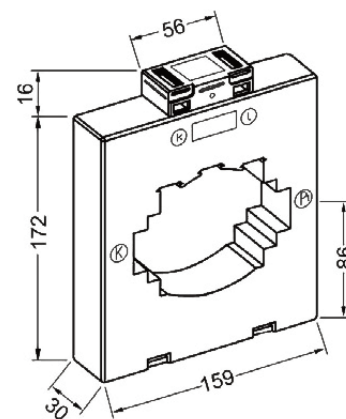
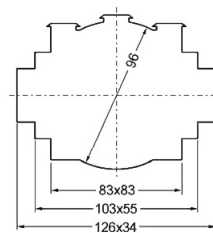

Technical Features, Executions

Primary rated current A	sec. 5 A / Rated burdens VA	
	Class 0.5	Class 1
400	-	2.5
500	-	5
600	-	5
750	10	15
800	10	15
1000	15	15
1250	15	15
1500	15	15
1600	15	15
2000	10	15
2500	15	30
3000	30	30
4000	30	30

Accessories (please indicate in the order):

- Mounting feet (2 pieces)

or

- primary fixing device

On request:

- Rated burden VA for secondary current 1A
- Other ranges, classes (0.2, 0.2S, 0.5S) or rated burden VA.

General Electrical Features

- Rated secondary current: 5A or 1A
- Frequency range 50 - 60Hz (other frequencies on request)
- Highest voltage for equipment: 720V
- Rated insulation level: 3kV/1 min
- Rated continuous thermal current: 1.2 times rated current
- Rated short-time thermal current (I_{th}): 60 times rated current
- Rated dynamic current (I_{dyn}): 2.5 times I_{th}
- Accuracy factor limit - FS < 5
- Thermal class of insulation: class E

General Mechanical Feature

- Cases of plastic, polyamide
- Cases self-extinguishing, according to UL 94 V0
- Nickel-plated secondary terminals
- Integrated secondary terminal covers

Environmental conditions

- Installation: Indoor use
- Operation temperature: - 5° C ... + 40°C
- Storage temperature: - 5° C ... + 40°C
- Altitude up to 1000 m

CURRENT TRANSFORMERS - AST SERIE

AST1256 - 1256V

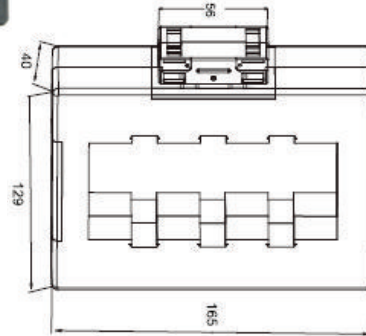
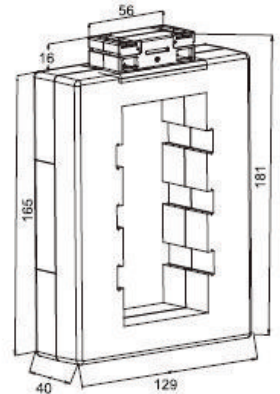
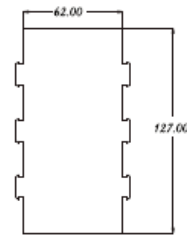
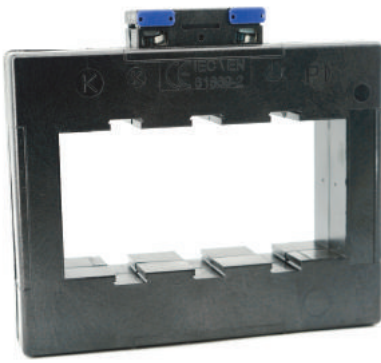

Dimensions (LxWxH):

AST1256	165 x 145 x 40	mm
AST1256V	129 x 181 x 40	mm

Primary busbar: 125 x 60 mm

Technical Features, Executions

Primary rated current A	sec. 5 A / Rated burdens VA	
	Class 0.5	Class 1
600	-	
750	5	
800	7.5	
1000	15	
1250	15	
1500	15	
1600	15	
2000	15	
2500	15	
3000	10	
3200	15	
3500	20	
4000	30	

Accessories (please indicate in the order):

- Mounting feet (2 pieces)
- or
- primary fixing device

On request:

- Rated burden VA for secondary current 1A
- Other ranges, classes (0.2, 0.2S, 0.5S) or rated burden VA.

General Electrical Features

- Rated secondary current: 5A or 1A
- Frequency range 50 - 60Hz (other frequencies on request)
- Highest voltage for equipment: 720V
- Rated insulation level: 3kV/1 min
- Rated continuous thermal current: 1.2 times rated current
- Rated short-time thermal current (I_{th}): 60 times rated current
- Rated dynamic current (I_{dyn}): 2.5 times I_{th}
- Accuracy factor limit - FS < 5
- Thermal class of insulation: class E

General Mechanical Feature

- Cases of plastic, polyamide
- Cases self-extinguishing, according to UL 94 V0
- Nickel-plated secondary terminals
- Integrated secondary terminal covers

Environmental conditions

- Installation: Indoor use
- Operation temperature: - 5° C ... + 40°C
- Storage temperature: - 5° C ... + 40°C
- Altitude up to 1000 m

CURRENT TRANSFORMERS - AST SERIE

AST1272



Dimensions (LxWxH): 159 x 188 x 30 mm

Primary busbar: 4 x 120 x 10 mm

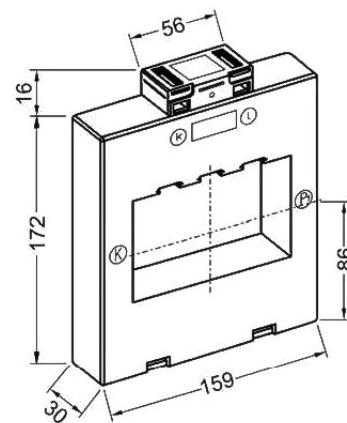
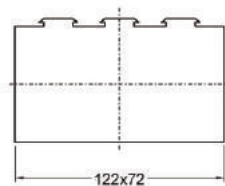

Technical Features, Executions

Primary rated current A	sec. 5 A / Rated burdens VA	
	Class 0.5	Class 1
400	-	2.5
500	-	5
600	1.5	5
750	2.5	10
800	2.5	10
1000	10	15
1250	15	15
1500	15	15
1600	15	15
2000	10	15
2500	15	30
3000	30	30
4000	30	30
5000	30	30
6000	30	30

Accessories (please indicate in the order):

- Mounting feet (2 pieces)

or

- primary fixing device

On request:

- Rated burden VA for secondary current 1A
- Other ranges, classes (0.2, 0.2S, 0.5S) or rated burden VA.

General Electrical Features

- Rated secondary current: 5A or 1A
- Frequency range 50 - 60Hz (other frequencies on request)
- Highest voltage for equipment: 720V
- Rated insulation level: 3kV/1 min
- Rated continuous thermal current: 1.2 times rated current
- Rated short-time thermal current (I_{th}): 60 times rated current
- Rated dynamic current (I_{dyn}): 2.5 times I_{th}
- Accuracy factor limit - FS < 5
- Thermal class of insulation: class E

General Mechanical Feature

- Cases of plastic, polyamide
- Cases self-extinguishing, according to UL 94 V0
- Nickel-plated secondary terminals
- Integrated secondary terminal covers

Environmental conditions

- Installation: Indoor use
- Operation temperature: - 5° C ... + 40° C
- Storage temperature: - 5° C ... + 40° C
- Altitude up to 1000 m

CURRENT TRANSFORMERS - AST SERIE

AST1656 - 1656V

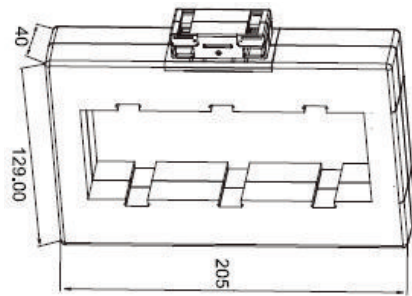
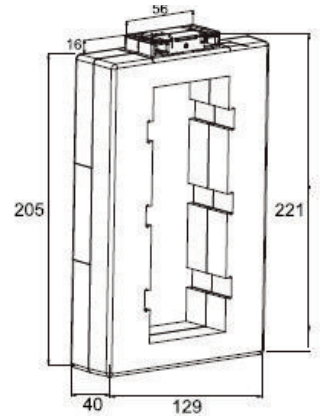
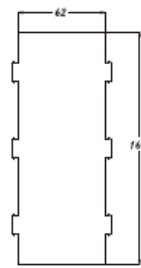
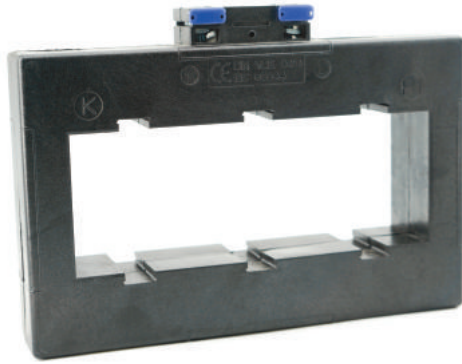

Dimensions (LxWxH):

AST1656 205 x 145 x 40 mm

AST1656V 129 x 221 x 40 mm

Primary busbar: 60 x 165 mm

Technical Features, Executions

Primary rated current A	sec. 5 A / Rated burdens VA	
	Class 0.5	Class 1
600	-	10
750	10	15
800	15	15
1000	15	15
1250	15	15
1500	15	15
1600	15	15
2000	15	20
2500	15	20
3000	15	20
3200	15	20
4000	15	20
5000	-	20

Accessories (please indicate in the order):

- Mounting feet (2 pieces)

or

- primary fixing device

On request:

- Rated burden VA for secondary current 1A
- Other ranges, classes (0.2, 0.2S, 0.5S) or rated burden VA.

General Electrical Features

- Rated secondary current: 5A or 1A
- Frequency range 50 - 60Hz (other frequencies on request)
- Highest voltage for equipment: 720V
- Rated insulation level: 3kV/1 min
- Rated continuous thermal current: 1.2 times rated current
- Rated short-time thermal current (I_{th}): 60 times rated current
- Rated dynamic current (I_{dyn}): 2.5 times I_{th}
- Accuracy factor limit - FS < 5
- Thermal class of insulation: class E

General Mechanical Feature

- Cases of plastic, polyamide
- Cases self-extinguishing, according to UL 94 V0
- Nickel-plated secondary terminals
- Integrated secondary terminal covers

Environmental conditions

- Installation: Indoor use
- Operation temperature: - 5° C ... + 40° C
- Storage temperature: - 5° C ... + 40° C
- Altitude up to 1000 m

CURRENT TRANSFORMERS - AST SERIE

AST1659 - 1659V

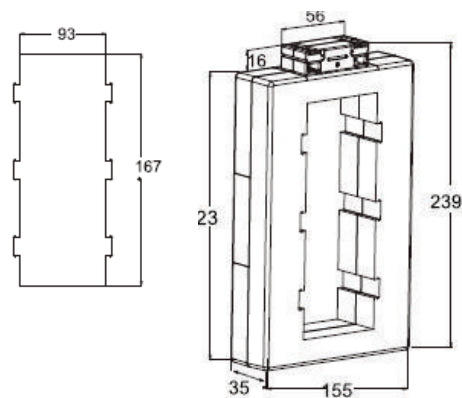
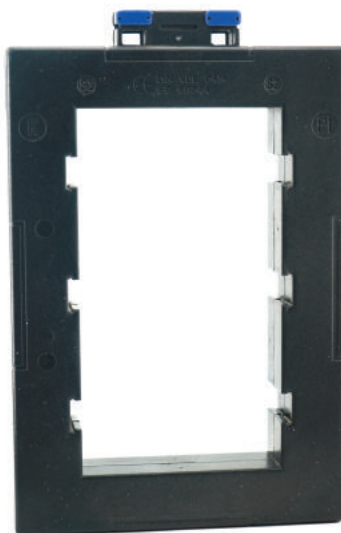
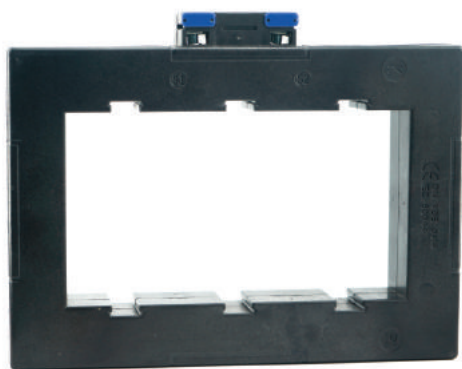

Dimensions (LxWxH):

AST1659	223 x 171 x 35	mm
AST1659V	155 x 236 x 35	mm

Primary busbar: 165 x 90 mm

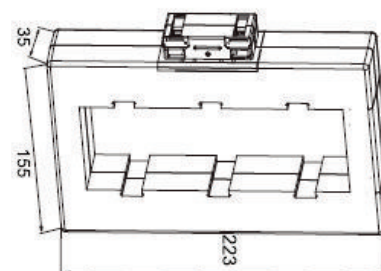

Technical Features, Executions

Primary rated current A	sec. 5 A / Rated burdens VA	
	Class 0.5	Class 1
800	-	15
1000	15	15
1250	15	15
1500	15	15
1600	15	20
2000	15	20
2500	15	20
3000	15	20
3200	15	20
3500	15	20
4000	15	20
5000	15	20
6000	15	20

Accessories (please indicate in the order):

- Mounting feet (2 pieces)

or

- primary fixing device

On request:

- Rated burden VA for secondary current 1A
- Other ranges, classes (0.2, 0.2S, 0.5S) or rated burden VA.

General Electrical Features

- Rated secondary current: 5A or 1A
- Frequency range 50 - 60Hz (other frequencies on request)
- Highest voltage for equipment: 720V
- Rated insulation level: 3kV/1 min
- Rated continuous thermal current: 1.2 times rated current
- Rated short-time thermal current (I_{th}): 60 times rated current
- Rated dynamic current (I_{dyn}): 2.5 times I_{th}
- Accuracy factor limit - FS < 5
- Thermal class of insulation: class E

General Mechanical Feature

- Cases of plastic, polyamide
- Cases self-extinguishing, according to UL 94 V0
- Nickel-plated secondary terminals
- Integrated secondary terminal covers

Environmental conditions

- Installation: Indoor use
- Operation temperature: - 5° C ... + 40° C
- Storage temperature: - 5° C ... + 40° C
- Altitude up to 1000 m

CURRENT TRANSFORMERS - AST SERIE

AST2065 - 2065V

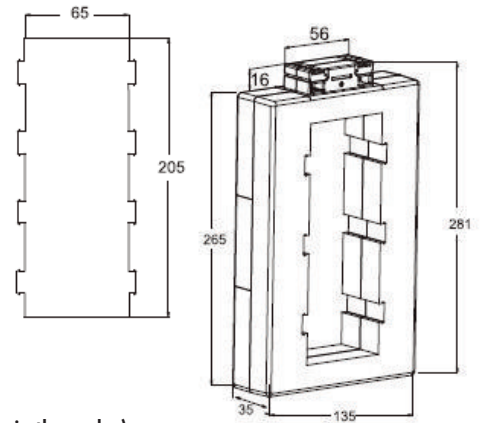
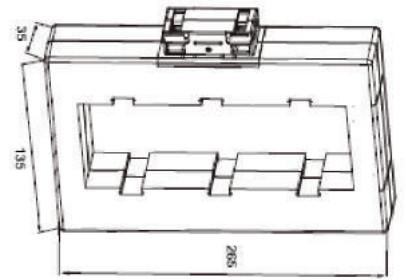
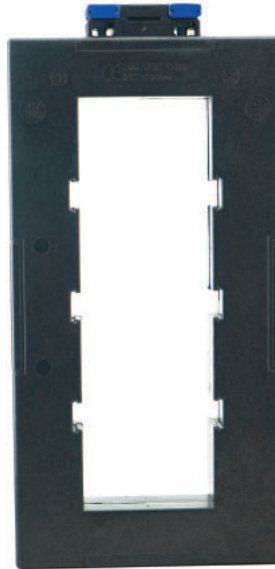

Dimensions (LxWxH):

AST2065 265 x 151 x 35 mm

AST2065V 155 x 236 x 35 mm

Primary busbar: 205 x 65 mm

Technical Features, Executions

Primary rated current A	sec. 5 A / Rated burdens VA	
	Class 0.5	Class 1
800	-	15
1000	15	15
1250	15	15
1500	15	15
1600	15	15
2000	15	15
2500	15	20
3200	15	20
4000	15	20
5000	15	20
6000	15	20

Accessories (please indicate in the order):

- Mounting feet (2 pieces)

or

- primary fixing device

On request:

- Rated burden VA for secondary current 1A
- Other ranges, classes (0.2, 0.2S, 0.5S) or rated burden VA.

General Electrical Features

- Rated secondary current: 5A or 1A
- Frequency range 50 - 60Hz (other frequencies on request)
- Highest voltage for equipment: 720V
- Rated insulation level: 3kV/1 min
- Rated continuous thermal current: 1.2 times rated current
- Rated short-time thermal current (I_{th}): 60 times rated current
- Rated dynamic current (I_{dyn}): 2.5 times I_{th}
- Accuracy factor limit - FS < 5
- Thermal class of insulation: class E

General Mechanical Feature

- Cases of plastic, polyamide
- Cases self-extinguishing, according to UL 94 V0
- Nickel-plated secondary terminals
- Integrated secondary terminal covers

Environmental conditions

- Installation: Indoor use
- Operation temperature: - 5° C ... + 40°C
- Storage temperature: - 5° C ... + 40°C
- Altitude up to 1000 m

CURRENT TRANSFORMERS - AST SERIE

AST3WST - AST4WST - AST4WPL6 - AST5WPL6 - AST5WPL8

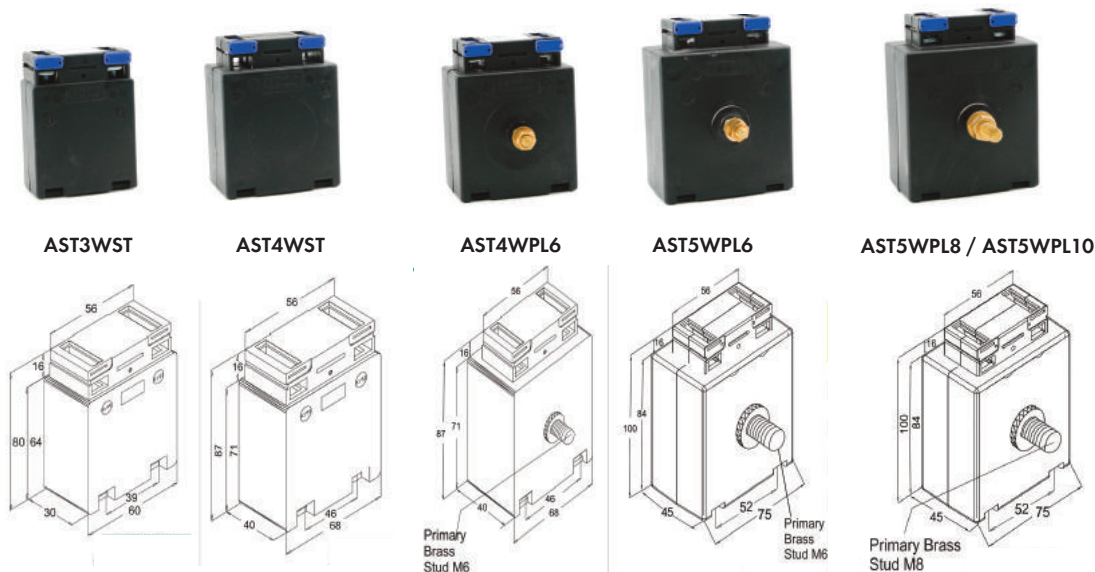

Technical Features, Executions

Primary rated current A	Class 1 / sec. 5 A / Rated burdens VA					
	AST3WST	AST4WST	AST4WPL6	AST5WPL6	AST5WPL8	AST5WPL10
5	5	10	5	15	-	-
6	5	10	5	15	-	-
7.5	5	10	5	15	-	-
10	5	10	5	15	-	-
12.5	5	10	5	15	-	-
15	5	10	5	15	-	-
20	5	10	5	15	-	-
25	5	10	5	15	-	-
30	5	10	5	15	-	-
50	-	-	-	-	15	-
60	-	-	-	-	15	-
75	-	-	-	-	15	-
80	-	-	-	-	15	15
100	-	-	-	-	-	15

Accessories:

- Mounting feet (2 pieces)

or

- DIN rail

On request:

- Rated burden VA for secondary current 1A

General Electrical Features

- Rated secondary current: 5A or 1A
- Frequency range 50 - 60Hz (other frequencies on request)
- Highest voltage for equipment: 720V
- Rated insulation level: 3kV/1min
- Rated continuous thermal current: 1.2 times rated current
- Rated short-time thermal current (I_{th}): 60 times rated current
- Rated dynamic current (I_{dyn}): 2.5 times I_{th}
- Accuracy factor limit - FS < 5
- Thermal class of insulation: class E

General Mechanical Feature

- Cases of plastic, polyamide
- Cases self-extinguishing, according to UL 94 V0
- Nickel-plated secondary terminals
- Integrated secondary terminal covers

Environmental conditions

- Installation: Indoor use
- Operation temperature: - 5° C ... + 40°C
- Storage temperature: - 5° C ... + 40°C
- Altitude up to 1000 m